



Flat 4 Kingsland Court Ravine Road, Canford Cliffs, Poole BH13 7HX
Offers Over £495,000 Share of Freehold





PRICED TO SELL WITH NO ONWARD CHAIN!! A SPACIOUS FLOOR FIRST apartment with a SOUTH FACING TERRACE and THREE DOUBLE BEDROOMS positioned in a QUIET LOCATION within the heart of Canford Cliffs Village and only a SHORT WALK to the areas AWARD WINNING BEACHES.

- FIRST FLOOR APARTMENT
- THREE DOUBLE BEDROOMS
- HEART OF CANFORD CLIFFS VILLAGE
- PRICED TO SELL
- WELL PRESENTED THROUGHOUT
- LARGE SUN TERRACE
- VACANT POSSESSION
- NO ONWARD CHAIN!!

Canford Cliffs

Canford Cliffs village is well known for being one of the most prestigious places to live, it has an assortment of café bars, restaurants and speciality shops with a wide variety of properties ranging from luxury apartments to contemporary designed cliff top residences. The apartment is adjacent to a pathway leading to Flaghead Chine with its sandy beaches. The world famous Sandbanks Peninsula and Poole Harbour are nearby with safe sandy beaches, marinas and yachts clubs as well as a whole host of water sports facilities. The 18 hole Championship Parkstone Golf Club is approximately a mile away whilst the more comprehensive towns of Poole and Bournemouth are approximately two miles equidistant.

Property Comprises

An exceptionally well presented, bright and spacious three double bedroom first floor apartment. The apartment is situated in a popular purpose built block and is just yards away from Canford Cliffs Village and is ideally located for the blue flag beaches at Flaghead Chine. The accommodation comprises of large open plan living/dining room, fitted kitchen/breakfast room, bathroom and en-suite to master bedroom. Additional features include the large south facing sun terrace which overlook the beautiful communal gardens, garage and ample storage.

Tenure - SHARE OF FREEHOLD

Maintenance - £3,124 per year approx Building Insurance, window cleaning, gardening, water and sewerage, cleaning and maintenance of communal areas, no pets allowed

Council Tax Band F

EPC: C





FIRST FLOOR
1198 sq.ft. (111.3 sq.m.) approx.

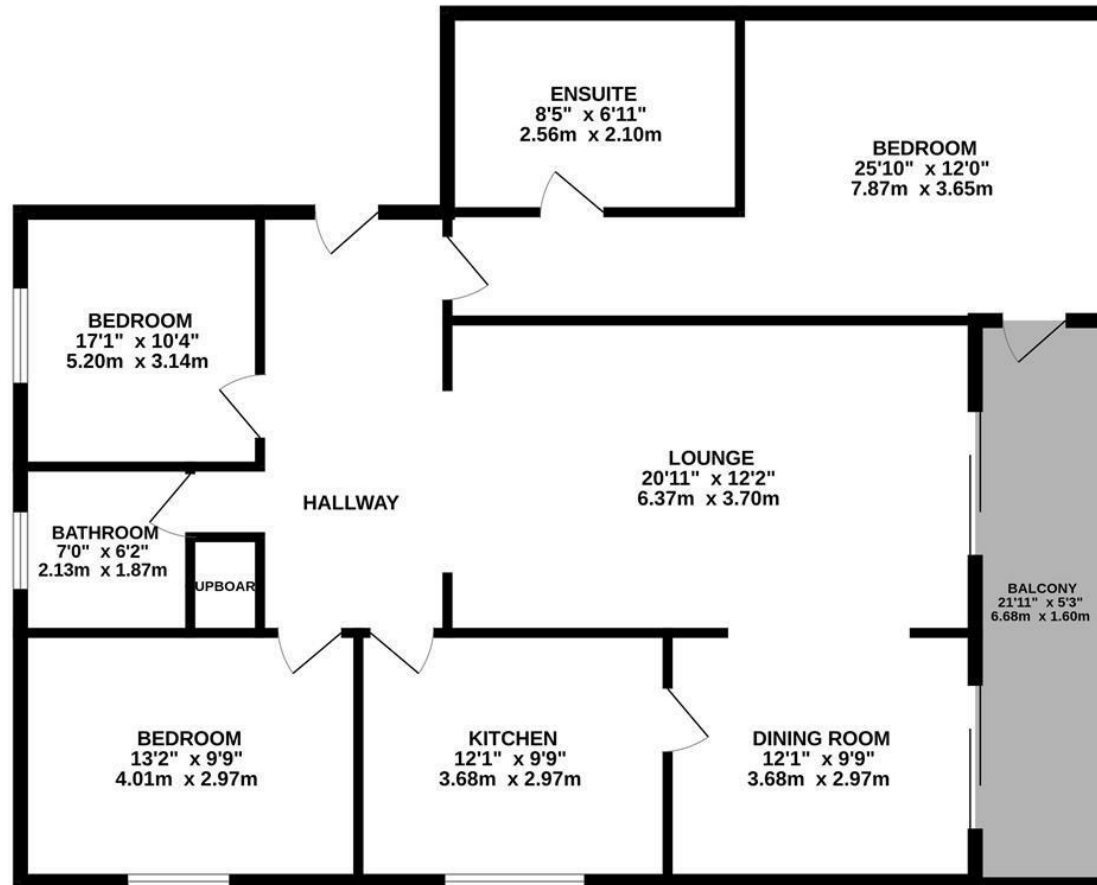

TOTAL FLOOR AREA: 1198 sq.ft. (111.3 sq.m.) approx.

Whilst every attempt has been made to ensure the accuracy of the floorplan contained here, measurements of doors, windows, rooms and any other items are approximate and no responsibility is taken for any error, omission or mis-statement. This plan is for illustrative purposes only and should be used as such by any prospective purchaser. The services, systems and appliances shown have not been tested and no guarantee as to their operability or efficiency can be given.
Made with Metreplex ©2023

Key Drummond

Tel: 01202 700771
canfordcliffs@keydrummond.com

www.keydrummond.com

All room dimensions given above are approximate measurements

These particulars are intended only to give a brief description of the property as a guide to prospective buyers. Accordingly:

- Their accuracy is not guaranteed and neither Key Drummond Estate Agents, nor the vendors accept any liability in respect of their contents.
- They do not constitute an offer of contract for sale.
- Any prospective purchasers should satisfy themselves by inspection or otherwise as to the correctness of any statements or information in these particulars. Please refer to the Agents if you require further clarification or information.

The Agent has not tested any apparatus, equipment, fixtures and fittings or services and so cannot verify that they are in working order or fit for the purpose. A buyer is advised to obtain verification from their Solicitor or Surveyor.

References to the Tenure of a Property are based on information supplied by the Seller. The Agent has not had sight of the title documents. A Buyer is advised to obtain verification from their Solicitor.

